



California Faucets®

TO-V4002-9, TO-V4002X-7, TO-V4002X-9, TO-V4102-7, TO V4102-9,
TO-V5202-7, TO-V5202-9, TS-52, D-52, DE-52, TO-V5302-7,
TO-V5302-9, TO-V5302F-7, TO-V5302F-9, TO-V5302K-7,
TO-V5302K-9, TO-VC102-7, TO-VC102-9, TO-VC102X-7,
TO-VC102X-9, TO-VC102XS-7, TO-VC102XS-9, TS-CI, D-CI, DE-CI

In-Wall Vessel Lavatory Faucet Installation Instructions

CALIFORNIA FAUCETS RECOMMENDS THAT ALL PLUMBING PRODUCTS BE INSTALLED
BY A LICENSED PROFESSIONAL

IMPORTANT: Read all instructions prior to installation and provide copy of instructions to consumer.

Operating Specifications:

Recommended Supply Pressure: 20 to 70 psi [1.4 to 4.8 bar] ^{††}

Maximum Flow Rate: 1.2 gpm [4.5 Lpm]

* Operating pressures between hot and cold supplies should vary no more than 30 psi [2.1 bar].

† If water pressure exceeds 70 psi [4.8 bar], install a Pressure-Reducing Valve (PRV).

I INSTALLING SPOUT TO IN-WALL VALVE

- Prior to installing faucet trim in-wall vessel rough VALVE (1), **VL-R**, must be properly installed and wall surface must be completely finished

NOTE: Recommended through-hole size shall be Ø1-1/4" [32mm]

- Slide spout RING (3) onto SPOUT (2)
- Apply thread sealant to threaded end of SPOUT (2) and tighten into center outlet of VALVE (1)
- If SPOUT (2) is not properly aligned when fully tightened, turn counter-clockwise till properly aligned

IMPORTANT: Do not overtighten SPOUT (2)

- Apply silicone caulk to back side of spout RING (3)
- Push spout RING (3) firmly against wall

NOTE: Spout installation shown with lavatory vessel valve, Tub Spout installation is the same

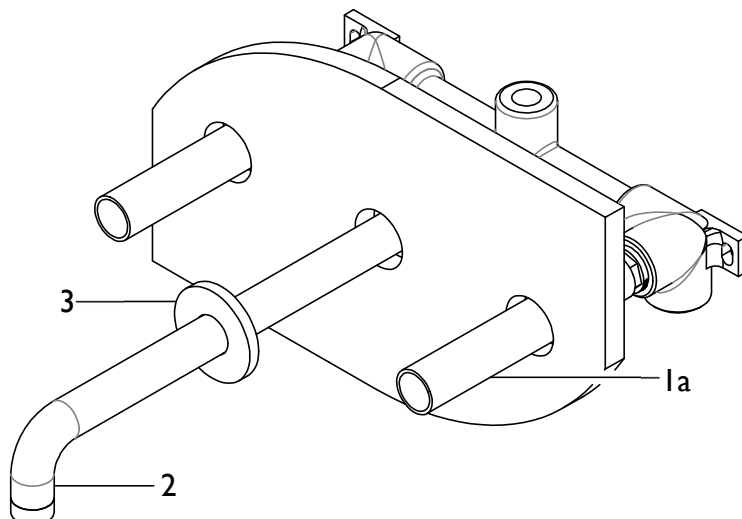
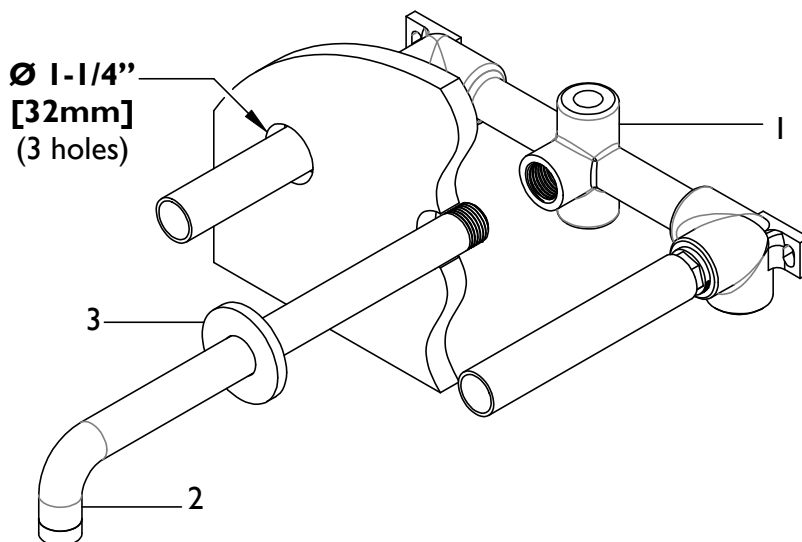

2

ALIGN & TRIM VALVE STEM

- Remove MUDGUARD (1a) from VALVE (1)
- To obtain proper HANDLE (5) alignment it may be necessary to re-align cartridge STEM (1b); to align STEM (1b), slightly loosen the cartridge NUT (1d), place HANDLE (11) on STEM (1b) and **TIGHTEN** in CW direction until desired alignment is achieved; retighten cartridge NUT (1d) to factory torque setting of 14 ft-lbs [19 Nm].

WARNING: Cartridge NUT (1d) **MUST** be properly torqued to prevent possible failure and/or water damage

- Using a marking device (e.g. pencil or marker) indicate a distance of 5/8" [16mm] from finished wall on ALL-THREAD (1c); unscrew ALL-THREAD (1c) from valve STEM (1b)
- Cut STEM (1b) 1-3/8" [25mm] from finished wall surface
- Cut off excess ALL-THREAD (1c) at indicated mark and reattach ALL-THREAD (1c) onto valve STEM (1b) – repeat on other side

Series	A" [mm]	B" [mm]
40	1-1/16" [27]	5/8" [16]
40X	1-1/16" [27]	5/8" [16]
41	1-1/8" [29]	1/4" [6]
52	1-3/8" [35]	5/8" [16]
53	1-3/8" [35]	5/8" [16]
CI	1-3/8" [35]	5/8" [16]

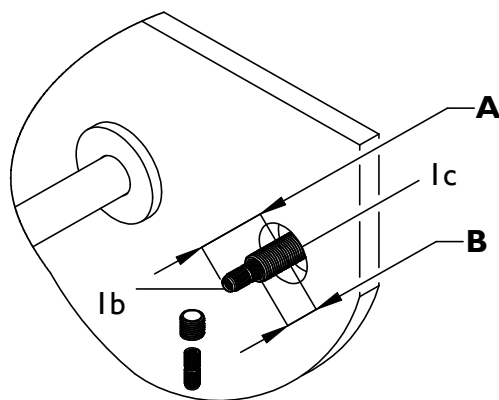
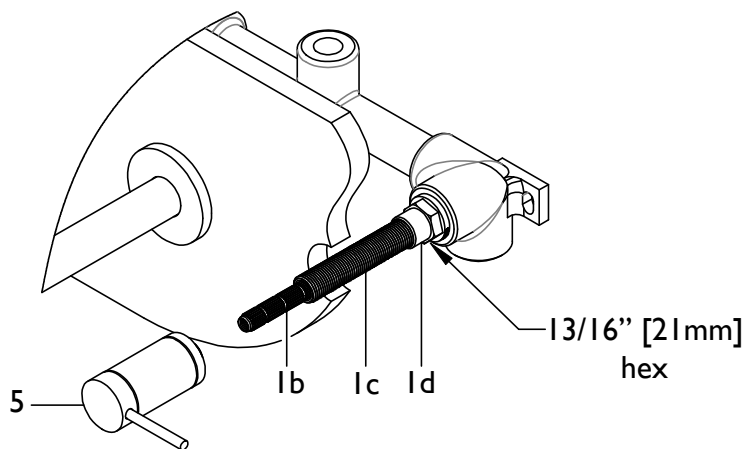

3

INSTALLING HANDLE

NOTE: Check that handle ESCUTCHEON (5b) spin independently of handle TOP (5a)

For 40, 40X, 52, 53 Series

- Tighten handle RING (4) onto HANDLE (5)

For 41 Series

- Fasten RING (4) onto ALLTHREAD (1c)
- Fasten ADAPTER (4c) to RING (4)
- Center WASHER (4a) onto ADAPTER (4c)
- Slide HANDLE (5) onto STEM (1b) and secure with SETSCREWS (5c)

For CI Series

- Place RING (4) and O-RING (4b) onto ALL-THREAD (1c)
- Place WASHER (4a) on top of RING (4)
- Slide HANDLE (5) down onto valve STEM (1b)
- Center WASHER (4a) onto ESCUTCHEON (5b)

For all

- Secure HANDLE (5) onto wall by tightening handle ESCUTCHEON (5b) onto ALL-THREAD (1c)
- Turn on water supply and check for leak

